

iOS Enrolment Guide

iOS Version: 12.0.1 | Workspace ONE | Intelligent Hub Version: 6.0.0



Based on your company's mobility requirements, enrolling your device will allow you to access corporate apps, and/or receive email, contacts and calendars.

Prerequisites

Email Address: This is your corporate/work email address

Network Credentials: This is your network username and password used to log into internal corporate systems.

Passcode: If you have set a passcode on your mobile device you will need this to set a new passcode during the enrolment if the passcode doesn't meet the passcode policy set by your IT team.

Apple ID: In order to download the Intelligent Hub app you will need to use or create an Apple ID

Connectivity: You will need an active 3G/4G or Wi-Fi connection

Battery: Ensure your device has been charged and has at least 50% of battery remaining to complete the enrolment



iOS Enrolment Guide

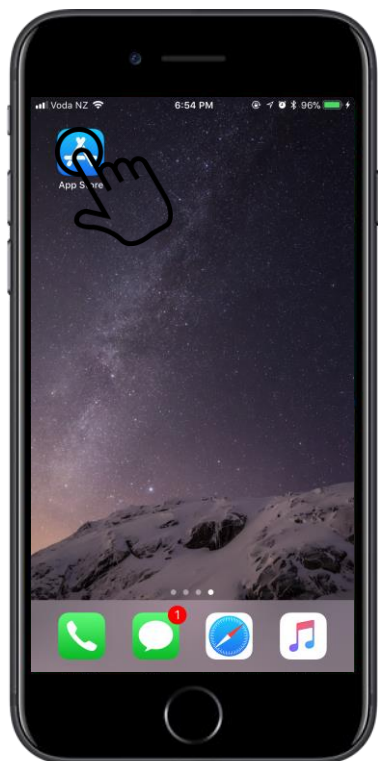

Step 1

Tap on the App Store

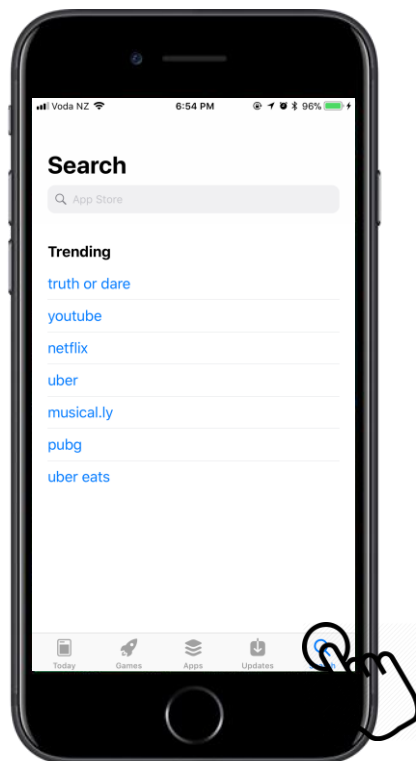

Step 2

Tap on Search

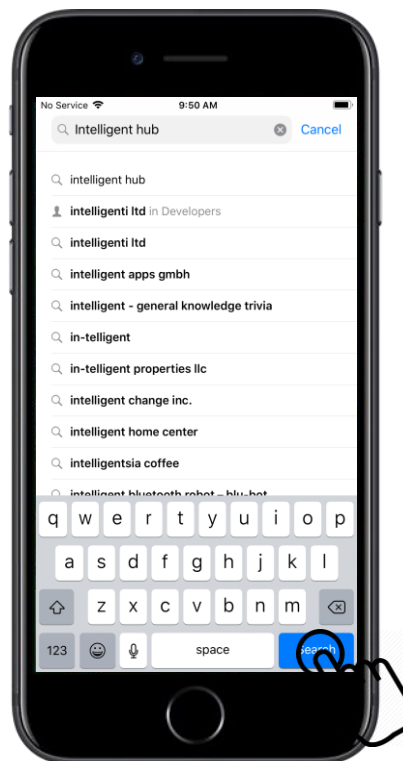

Step 3

Type Intelligent Hub and tap Search

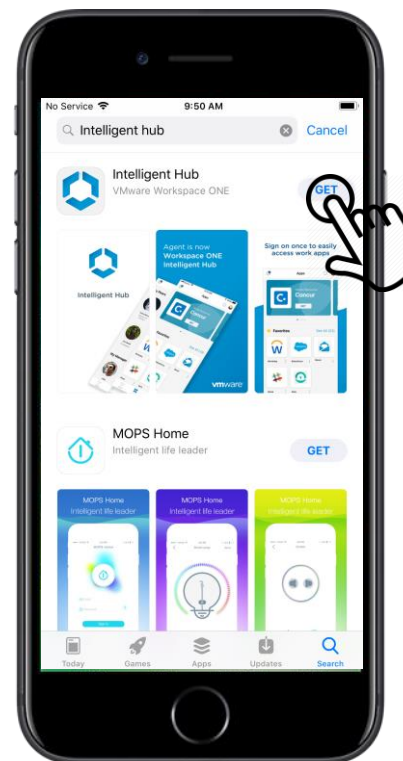

Step 4

Select Intelligent Hub then tap GET

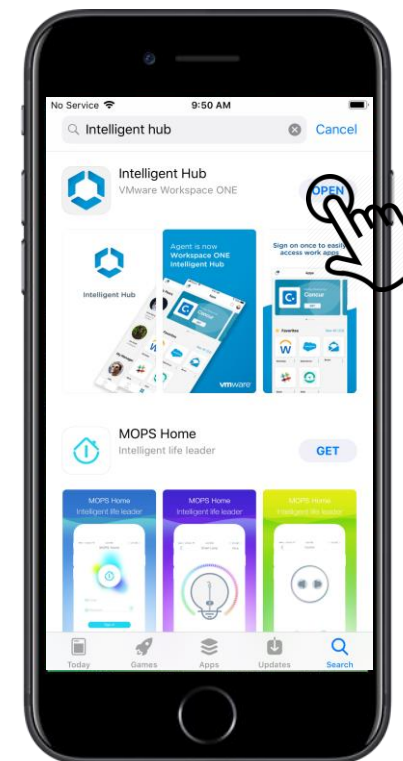

Step 5

Tap OPEN

iOS Enrolment Guide

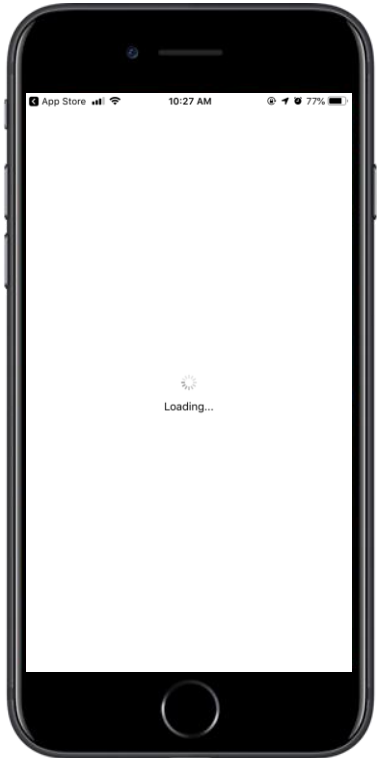

Step 6

Wait for app to load

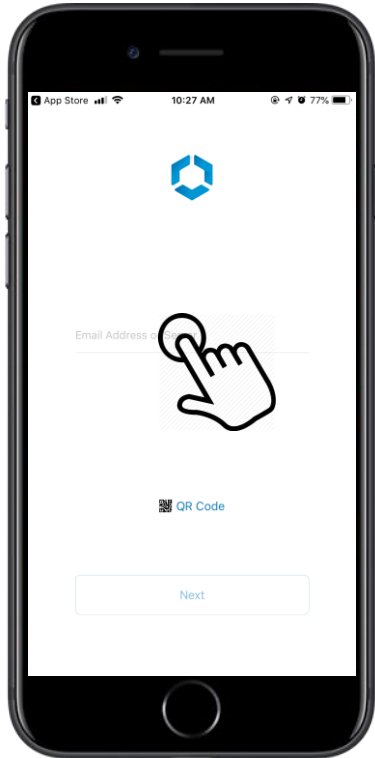

Step 7

Enter your network Email address

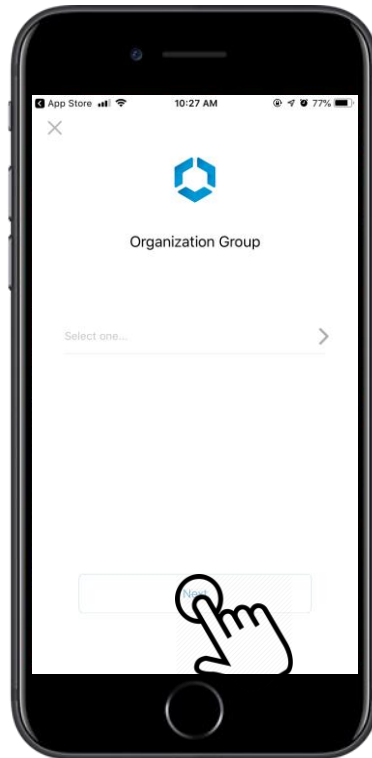

Step 8

Select the appropriate group then tap **Next**

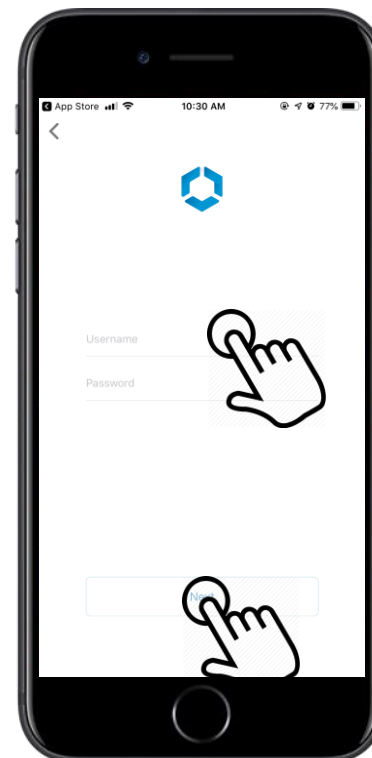

Step 9

Enter your username and password then tap **Next**

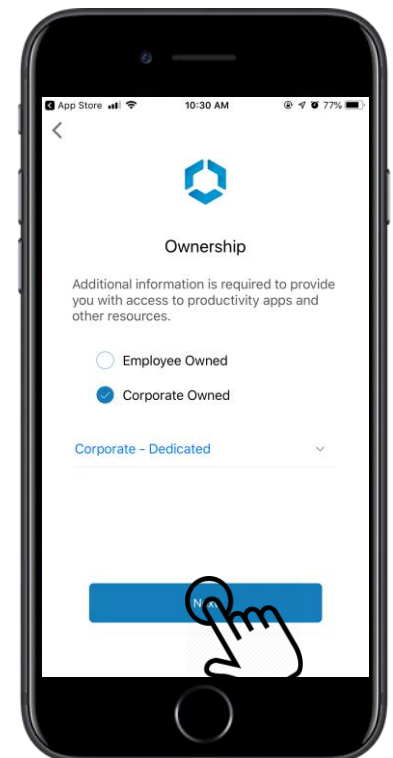

Step 10

Select **Corporate – Dedicated** and tap **Next**

iOS Enrolment Guide

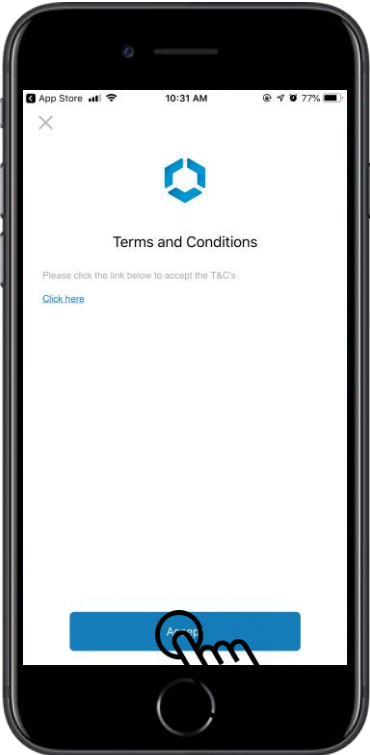

Step 11

Tap Accept

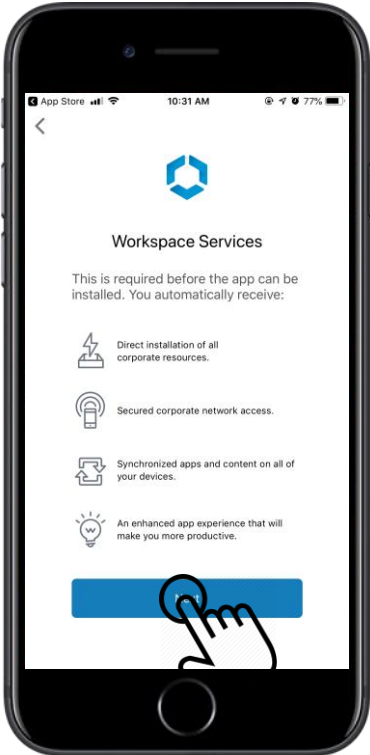

Step 12

Tap Next

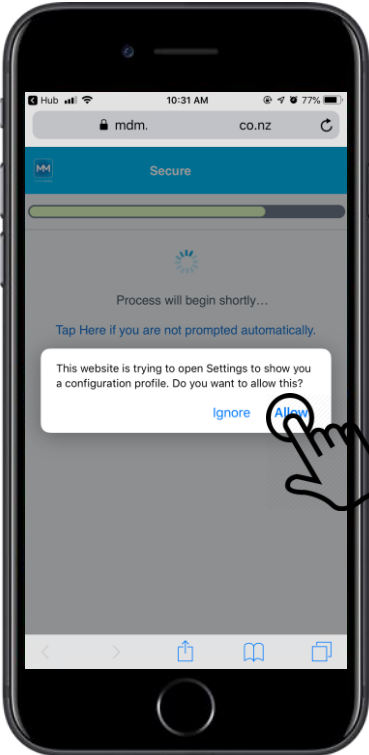

Step 13

Tap Allow

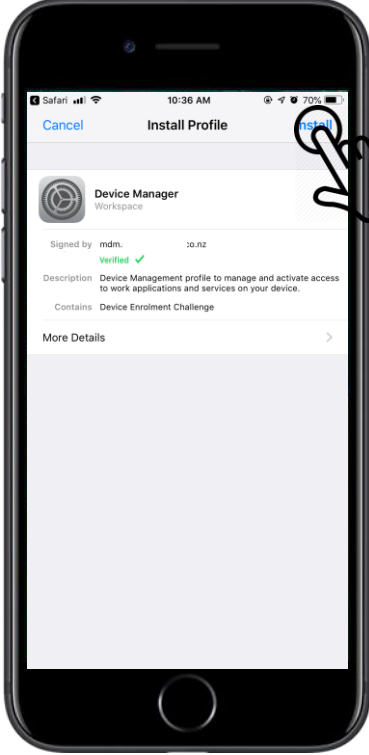

Step 14

Tap Install

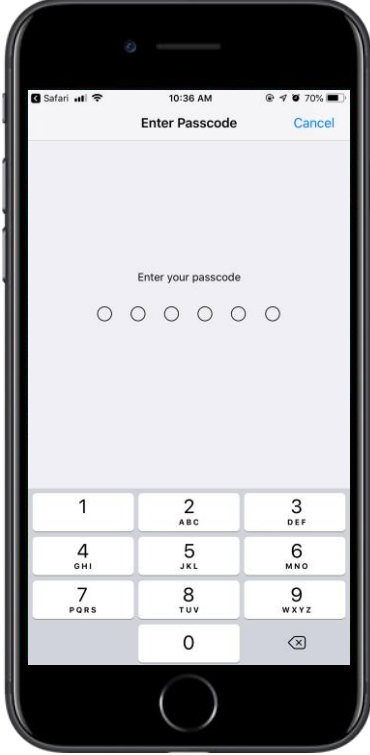

Step 15

Enter your phone passcode

iOS Enrolment Guide

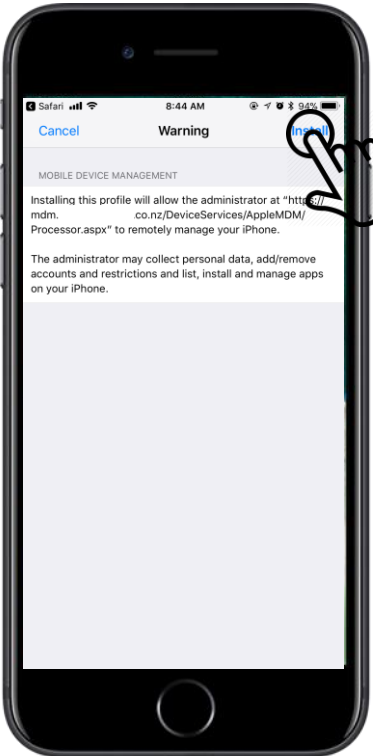

Step 16

Tap Install

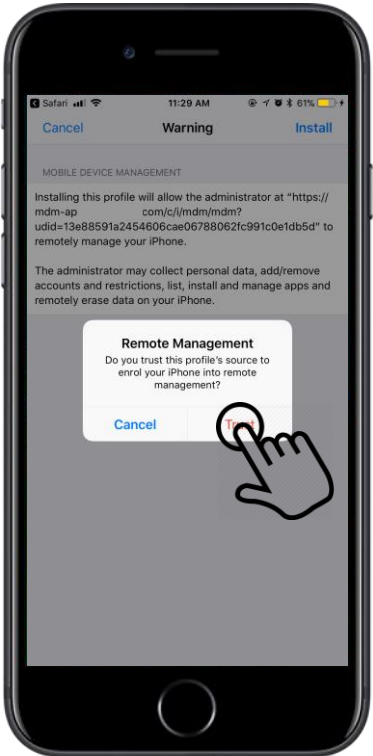

Step 17

Tap Trust

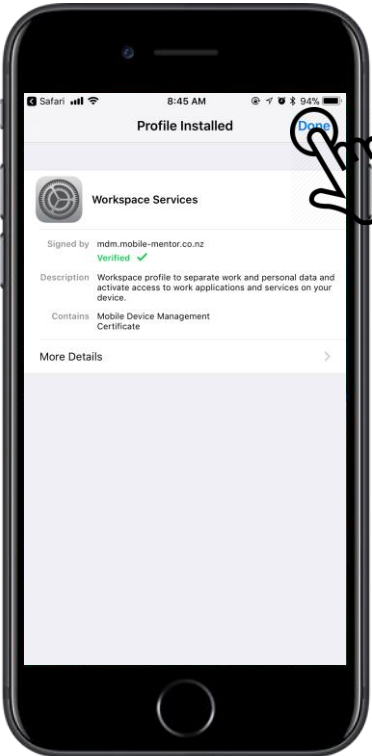

Step 18

Tap Done

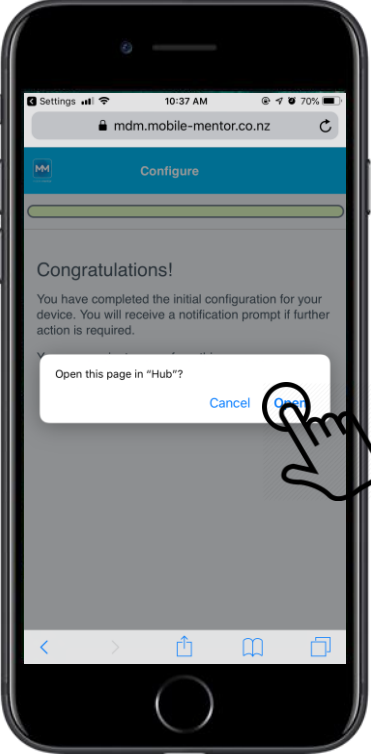

Step 19

Tap Open

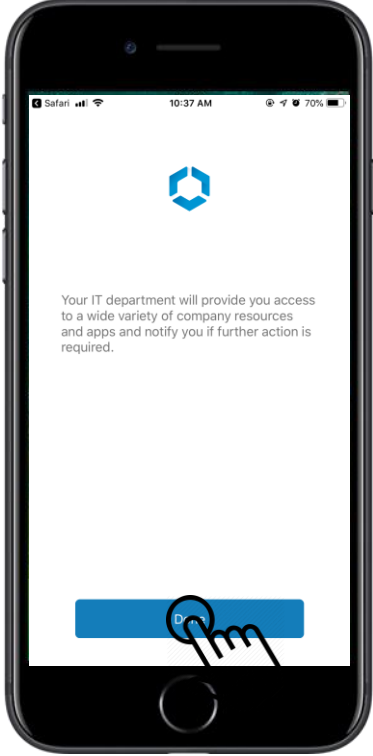

Step 20

Tap Done

iOS Enrolment Guide

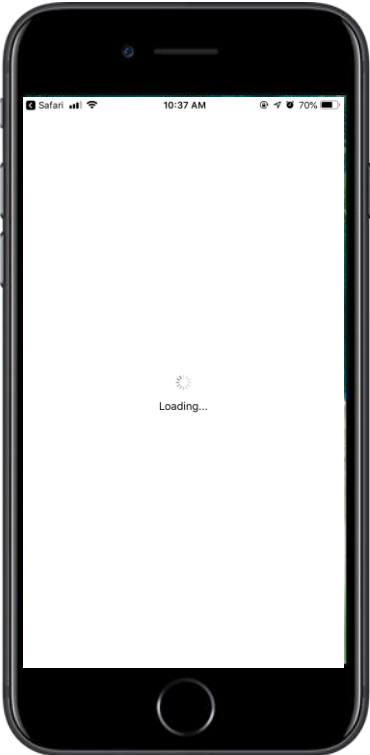

Step 21

Please wait

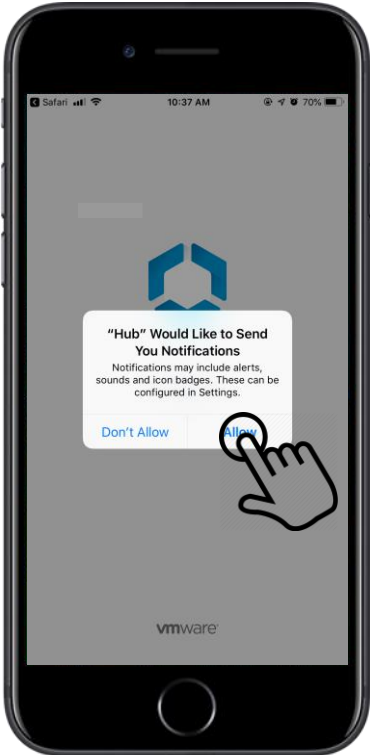

Step 22

Tap Allow

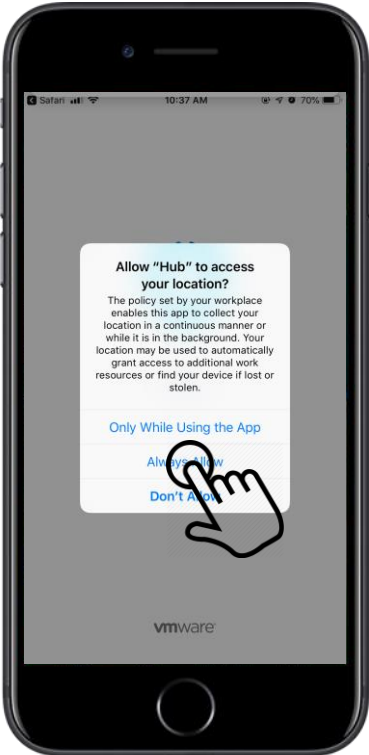

Step 23

Tap Always Allow

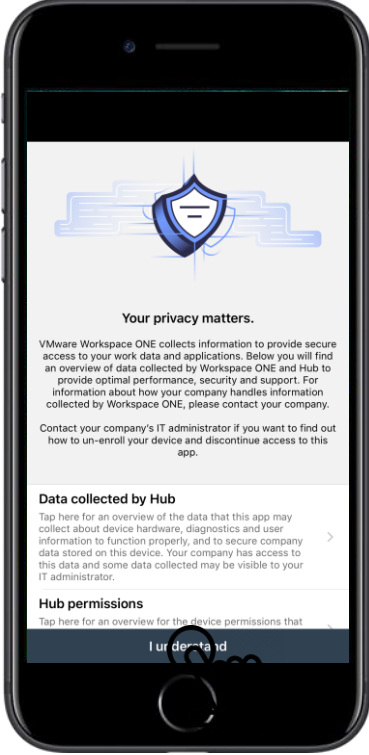

Step 24

Tap I understand

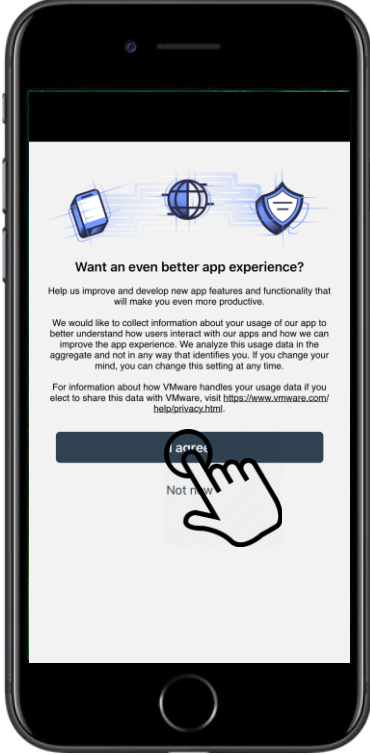

Step 25

Tap I agree



iOS Enrolment Guide

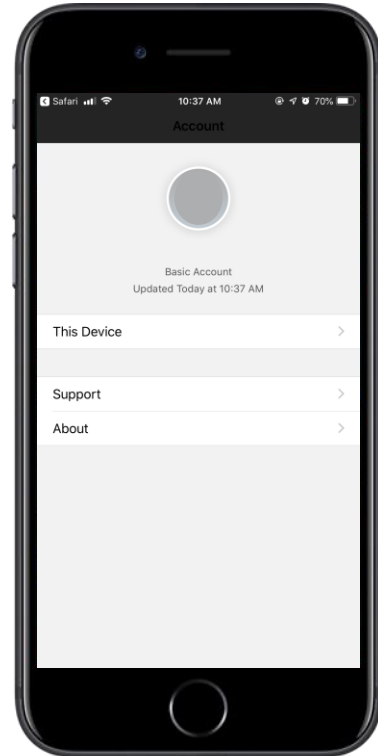

Step 26

You have now completed the Workspace ONE enrolment



Congratulations!

You have now completed the Workspace ONE enrolment.

If you require further support, please contact us on: support@mobile-mentor.com