



# Android Enrolment Guide

Android Version: 8.1.0 | Intune | Intune Company Portal: 5.0.4206.0 | Example Device: Nokia 7 Plus

Note: This device guide is based on the above listed device and operating system version, steps may differ for different device or operating system versions.  
Refer to [support.mobile-mentor.com](https://support.mobile-mentor.com) for detailed support articles.



Based on your company's mobility requirements, enrolling your device will allow you to access corporate apps, and/or receive email, contacts and calendars.

The enrolment process will take approximately between 15 to 45 minutes

## Prerequisites

- ❑ **Email Address:** This is your corporate/work email address
- ❑ **Network Credentials:** This is your network username and password used to log into internal corporate systems.
- ❑ **Passcode:** You will need to know your current passcode on your mobile device. If your current passcode doesn't meet the passcode policy set by your IT team, you will be prompted to change this during the process.
- ❑ **Google Account:** In order to download the Intune Company Portal app, you will need a google account. Click [here](#) to create a google account.
- ❑ **Connectivity:** You will need an active 3G/4G or Wi-Fi connection
- ❑ **Battery:** Ensure your device has been charged and has at least 50% of battery remaining to complete the enrolment



# Android Enrolment Guide

Android Version: 8.1.0 | Intune | Intune Company Portal: 5.0.4206.0 | Example Device: Nokia 7 Plus

Note: This device guide is based on the above listed device and operating system version, steps may differ for different device or operating system versions.  
Refer to [support.mobile-mentor.com](http://support.mobile-mentor.com) for detailed support articles.



## Step 1

Tap on the **Play Store** app

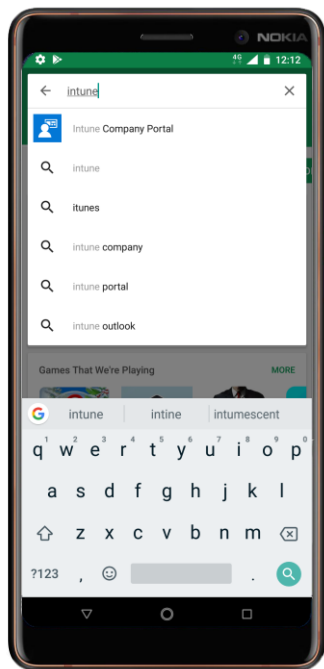

## Step 2

Search and select the **Intune Company Portal** app

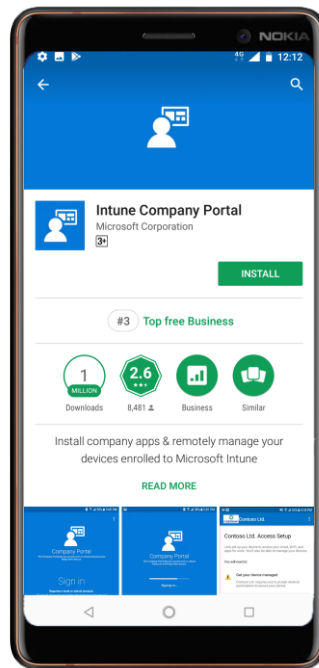

## Step 3

Tap on **INSTALL**

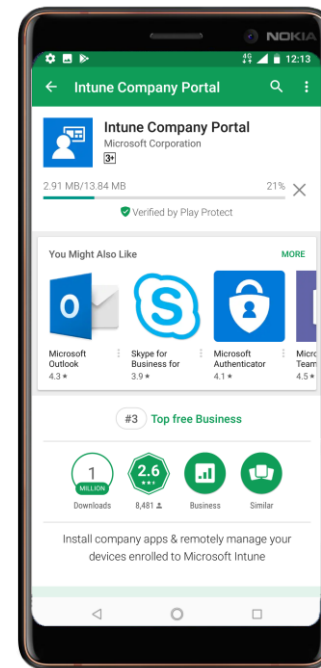

## Step 4

Wait for the app to install

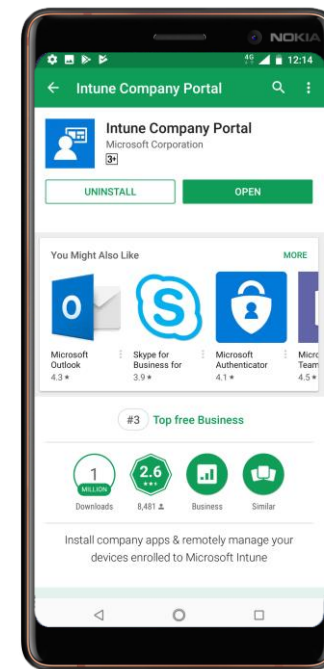

## Step 5

Tap **OPEN**



# Android Enrolment Guide

Android Version: 8.1.0 | Intune | Intune Company Portal: 5.0.4206.0 | Example Device: Nokia 7 Plus



Note: This device guide is based on the above listed device and operating system version, steps may differ for different device or operating system versions.  
Refer to [support.mobile-mentor.com](https://support.mobile-mentor.com) for detailed support articles.

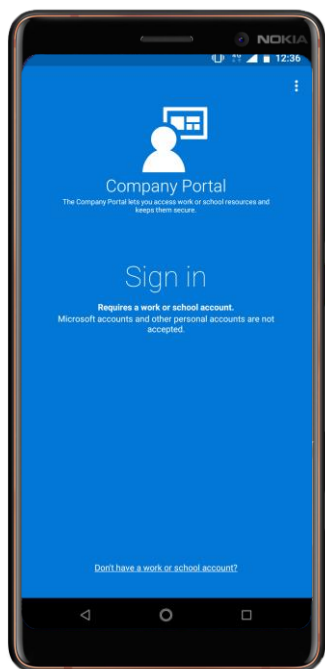

## Step 6

Tap on **Sign in**

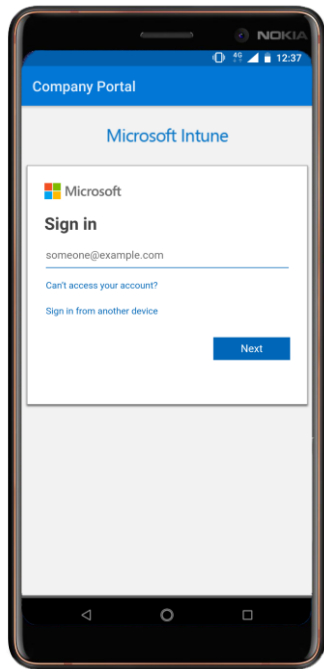

## Step 7

Enter your company Email address and tap **Next**

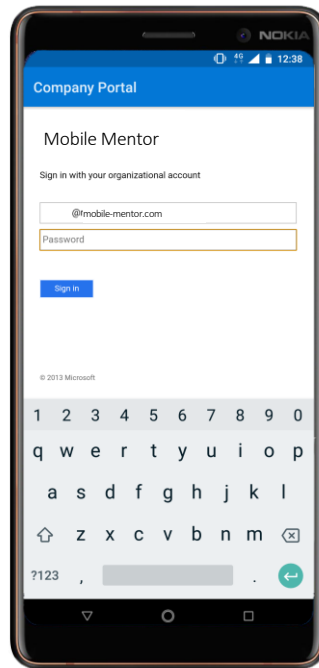

## Step 8

Enter your password and tap **Sign in**

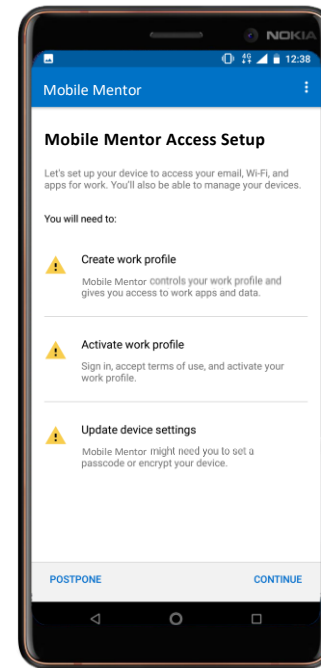

## Step 9

Tap **CONTINUE**

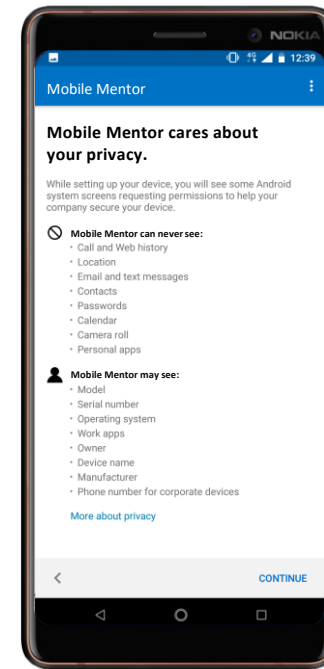

## Step 10

Tap **CONTINUE**



# Android Enrolment Guide

Android Version: 8.1.0 | Intune | Intune Company Portal: 5.0.4206.0 | Example Device: Nokia 7 Plus



Note: This device guide is based on the above listed device and operating system version, steps may differ for different device or operating system versions.  
Refer to [support.mobile-mentor.com](https://support.mobile-mentor.com) for detailed support articles.

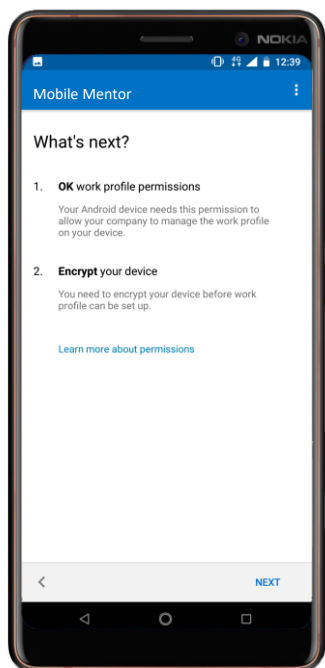

## Step 11

Tap **NEXT** and wait while your device is registered

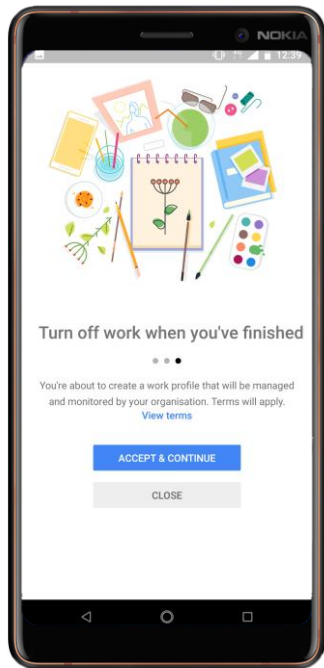

## Step 12

Select **ACCEPT & CONTINUE**

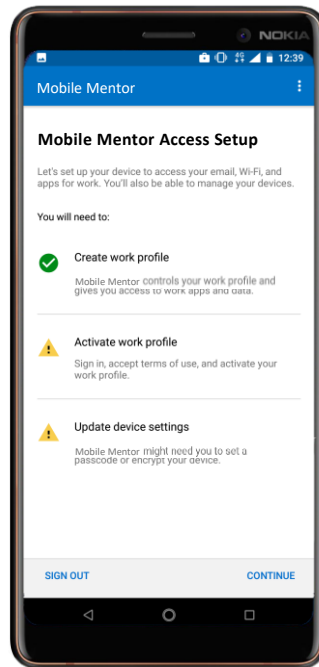

## Step 13

Tap **CONTINUE**

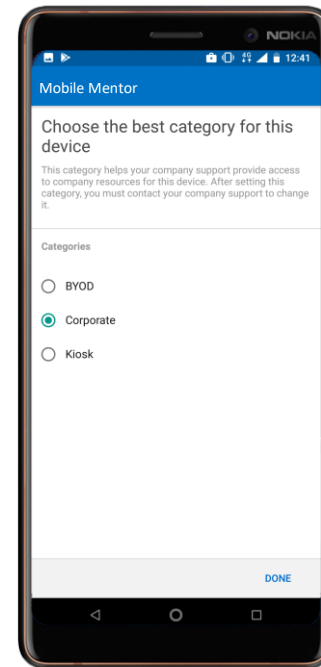

## Step 14

Select **Corporate** then tap **DONE**

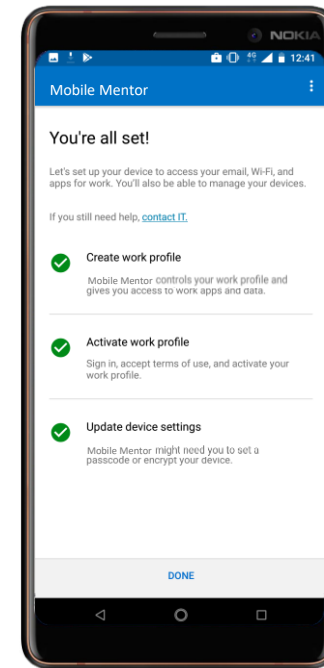

## Step 15

Tap **DONE**



# Android Enrolment Guide

Android Version: 8.1.0 | Intune | Intune Company Portal: 5.0.4206.0 | Example Device: Nokia 7 Plus



Note: This device guide is based on the above listed device and operating system version, steps may differ for different device or operating system versions.

Refer to [support.mobile-mentor.com](https://support.mobile-mentor.com) for detailed support articles.

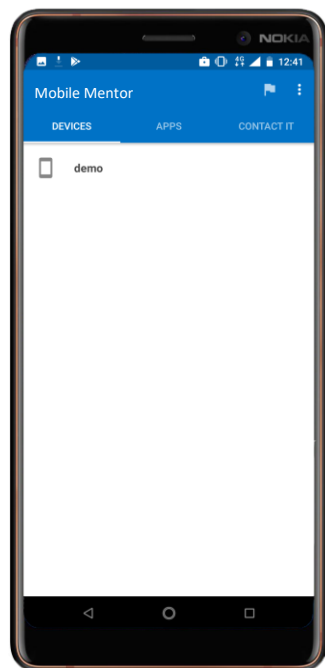

## Step 16

Your device is now enrolled. Tap the **Home button**

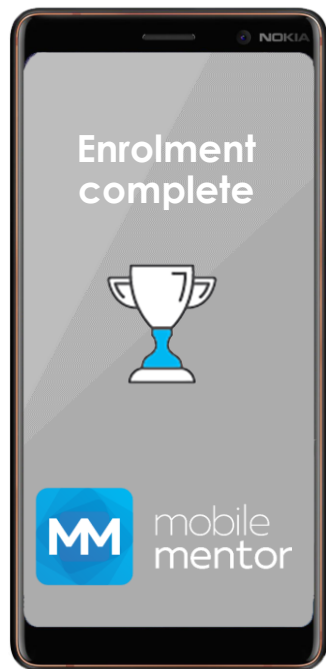

## Completed!

If you require further support, please contact us

[support@mobile-mentor.com](mailto:support@mobile-mentor.com)